

COLD CHISELS

- › Made from S2 steel and specially heat-treated for greater strength and durability.
- › Hand ground cutting edge to the exact angle for cutting through tough metals.
- › Modified parabolic striking end to help reduce mushrooming and chipping.
- › Black oxide finish to help prevent rust corrosion; extending tool life and performance.
- › A polished identification panel on one of the flats is marked with the tool number and size in a black inlay.



Product #	Tip Width (in) (A)	Shank Width (in) (B)	Overall Length (in) (L)	Weight (lbs)
J86A3/16S2	1/4	3/16	4-7/8	0.04
J86A1/4S2	5/16	1/4	5-1/8	0.07
J86A5/16S2	3/8	5/16	5-3/8	0.12
J86A3/8S2	7/16	3/8	5-9/16	0.17
J86A7/16S2	1/2	7/16	6	0.25
J86A7/16X12S2	1/2	7/16	12	0.51
J86A1/2S2	5/8	1/2	6-3/4	0.37
J86A1/2X12S2	5/8	1/2	12	0.68
J86A5/8S2	3/4	5/8	6-7/8	0.54
J86A5/8X12S2	3/4	5/8	12	1.03
J86A3/4X8S2	7/8	3/4	8	0.89
J86A3/4X12S2	7/8	3/4	12	1.40
J86A7/8X18S2	1	7/8	18	2.42
J86A7/8X8S2	1	7/8	8	1.13
J86A7/8X12S2	1	3/4	12	1.54
J86A1X8S2	1-3/16	1	8-1/4	1.56

ASME B107.47M

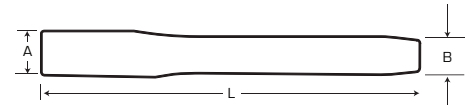

5 PIECE SUPER-DUTY CHISELS SET

Product #: **J86000**

- › Made from S2 steel and specially heat-treated for greater strength and durability.
- › 20% Larger striking surface than standard chisels directs the power to the cutting edge.
- › Longer shank features a knurl for better grip and easy positioning.
- › Hand ground cutting edge to the exact angle for cutting through tough metals.
- › Black oxide finish to help prevent rust corrosion; extending tool life and performance.
- › A polished identification panel on one of the flats is marked with the tool number and size in black inlay.
- › Set offers a wide range of sizes to handle a variety of jobs.
- › Includes a pouch for convenient storage solution.



Contents	Description	Tip Width (in) (A)	Shank Width (in) (B)	Overall Length (in) (L)
J86038	Chisel, Cold Super Duty 3/8"	3/8	5/16	6
J86012	Chisel, Cold Super Duty 1/2"	1/2	7/16	6-13/16
J86058	Chisel, Cold Super Duty 5/8"	5/8	1/2	7-5/8
J86034	Chisel, Cold Super Duty 3/4"	3/4	5/8	8-7/16
J86078	Chisel, Cold Super Duty 7/8"	7/8	3/4	9-1/4
J25TR06C	Tool Roll, 5 Pocket			

Weight (lbs): 2.84

